

Meaningful. MEMORABLE. *Moments.*

2024



The
William
Inglis

MGALLERY SOUTH WEST SYDNEY



OUR PLACE *your story*

Celebrating racing history and the thoroughbred industry, The William Inglis is a 5 star boutique equine themed property. The William Inglis is part of the MGallery Hotel Collection, a series of luxury hotels that feature memorable designs and unique stories to tell.

Located in the South West of Sydney and nestled in the scenic Riverside Stables Precinct. The property is situated only 30 minutes from Sydney Airport and 45 minutes from the Sydney CBD.

The property features:

144 Accommodation Rooms

The Newmarket Room Restaurant

Heroic Café & 1867 Bar Lounge

Chiltern Rooftop Pool

Room Service

Fitness Centre

Spa and Wellness Centre

Retail Shop

800 Complimentary Parking Spaces





EVENT *Spaces*



The
William
Inglis

MGALLERY SOUTH WEST SYDNEY





THE SALES *arena*

1440 sqm

The Sales Arena offers the ideal space for any showcase, concerts, conferences or gala style events. The Sales Arena is a versatile space catering up to 1000 people with a variety of seating options including theatre, classroom or banquet style set up. Featuring the latest in audio visual equipment. access to inbuilt screens and high-speed internet. The Sales Arena has a built in stage and podium which is optimal for presentations.

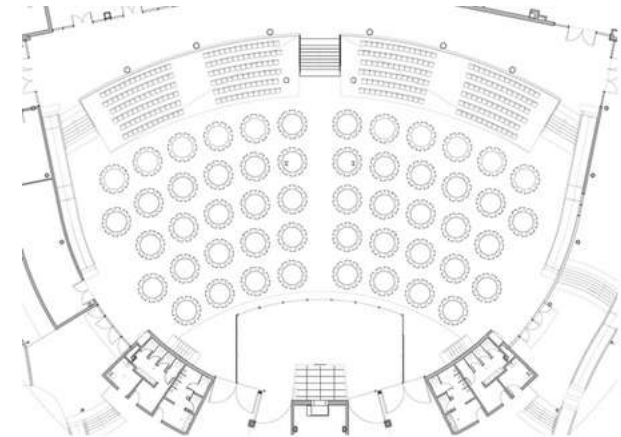



THE SALES *arena*



THE BIG *barn*

720 sqm

Nestled alongside the Riverside Stable Gardens, The Big Barn is the perfect venue for larger groups. A rustic design with modern facilities. Modeled from the original Newmarket Barn designed over 150 years ago, The Big Barn has a warm feel with rural ambience that you and your guests will become immersed in. With additional access to surrounding gardens, this venue allows complete versatility for your event. The Big Barn is fully air-conditioned with access to the latest AV equipment, including television screens, speakers and Wi-fi. It also has its own bathrooms and is wheelchair accessible.

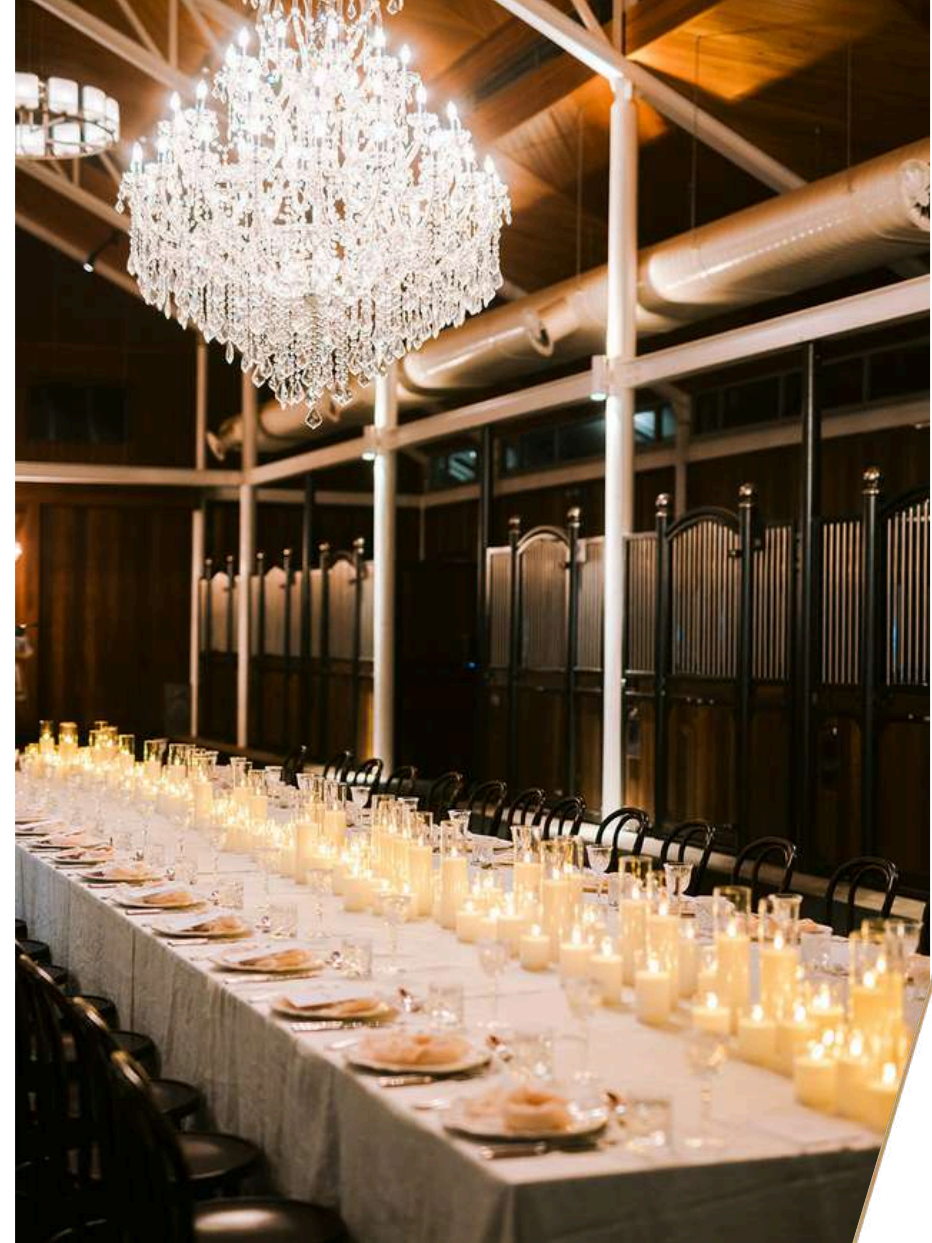
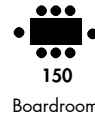
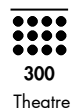
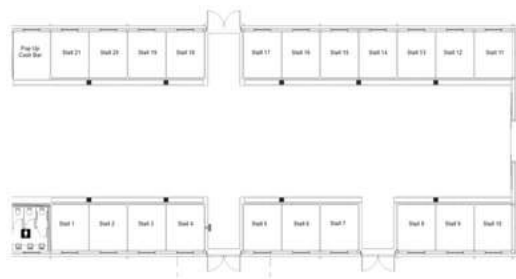



THE BIG *barn*



THE GARDEN *pavilion*

166 sqm

Among the striking gardens of Riverside Stables, The Garden Pavilion is an elegant function room featuring glass floor to ceiling bi-folding doors. These doors open out on to the surrounding gardens providing you with both outdoor and indoor options. Overlooking Warwick Farm Racecourse, it is perfect for private functions, social events, and celebrations. Access to Wi-Fi, in built screens and Audio-Visual equipment. This room can be used as a private conference space or breakout room with plenty of natural light and garden views.

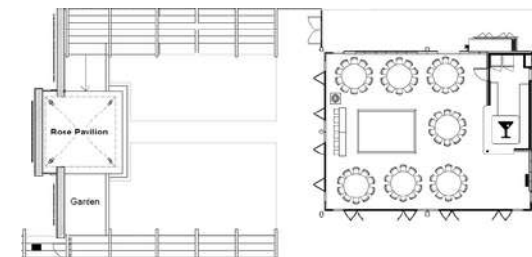

80
Banquet

64
Cabaret

120
Cocktail

110
Theatre

40
Classroom

30
Boardroom



Ellian

Ellian

THANK YOU
FOR BEING MY
Godparents

THE GARDEN pavilion

PRIVATE *pavilions*

125 sqm

The Private Pavilion features glass sliding doors opening out to the parade ring and Riverside Stables providing you with access to both indoor and outdoor options. The Private Pavilion is fully air-conditioned with access to Wi-Fi, in built screens and the latest in Audio-visual equipment. Suitable for a private event or perfect for breakout spaces



Banquet



Cabaret



Cocktail



Theatre



Classroom



Boardroom







Exclusive Hire not available - Friday and Saturday

1867 BAR & *lounge*

213 sqm

Located on the Mezzanine level of the hotel, the 1867 Lounge is a sophisticated, intimate space that is ideal for smaller gatherings and events. The Lounge has a private bar and access to plasma television screens, speakers and WIFI.

The lounge is decorated with custom-made furniture, a fire place and a large bookcase that is filled with relics of the racing industry in Australia. The space is perfect for night time event or to be used as a meeting space prior to or post an event.

Note: The 1867 Lounge is not available for exclusive hire on Friday and Saturday when it is open to general public.



70

Cocktail

HIGH *tea*

Host an elegant High Tea at The William Inglis for your special event.

\$70 per person

\$40 per child

SAVOURY

Pulled beef, cornichons and cheese slider (SF)

Chicken cocktail pie

Spinach and onion fritters (GF, DF, NF, SF)

FINGER SANDWICHES

Chicken, celery and mayonnaise

Salmon and cream cheese

Curried egg and lettuce

DESSERTS

Friands (GF, DF)

Portuguese custard tart (V, NF)

Chocolate brownie

CHILDRENS MENU

Ham and cheese finger sandwich

Sausage roll

Chocolate brownie

Includes bottomless tea and coffee





CANAPE *package*

1 Hour Menu - 4 Canapes \$35 per person
2 Cold and 2 Hot

2 Hour Menu - 6 Canapes \$65 per person
3 Cold, 3 Hot and 1 Substantial (6 Canapes)

Menu Selections Available

PLATED *menu*

Two Course Set Menu \$75.00 per person
Three Course Set Menu \$85.00 per person

Menu Selections Available

FOOD *stations*

FROMAGE PLATTER

Indulge in our selection of Australian and gourmet cheeses paired with cured meats, served with crackers and toasted sourdough

\$20 Per Person

ANTIPASTO STATION OR PLATTER

Chef selection of cured meats, Italian mixed olives, dried fruits and nuts, chef selection of 2 cheeses. served with bread sticks, bread and crackers.

\$25 Per Person

MEZZE STATION OR PLATTER

A middle eastern inspired array of breads, dips, olives, grilled vegetables. With your choice of dolmades or falafel.

\$20 Per Person

SEAFOOD

Natural oysters
Served on ice with salmon keta caviar, yuzu pearls, Australian prawns
Sashimi served with soy sauce and pickled ginger

\$45 Per Person

LET'S ROLL - SUSHI

Sashimi served with soy sauce and pickled ginger
Assorted sushi rolls - chef's selection

\$35 Per Person

A TASTE OF MEXICO

Fresh tasty ingredients to build your perfect taco!
• Soft and hard shell tacos
• An array of Mexican inspired sides, dishes and condiments

\$25 Per Person

BUILD A BURGER STATION

Create your own burger with either beef or chicken. Accompanied by a variety of buns and condiments.

\$25 Per Person





LIVE FOOD *stations*

OYSTER SHUCKING STATION

\$25 Per Person

Sydney rock oysters

- Natural
- Mignonette
- Lemon wedges and seaweed

PIZZA AND PASTA WHEEL STATION

\$80 Per Person

Selection of 3 Pastas and 2 Pizzas

Pasta Selections Below

Penne napoletana
Penne bosciola
Penne arrabiata
Linguine creamy marinara
Creamy vegetarian

Pizza Selections Below

Pepperoni
Margherita
Vegetarian
Ham and pineapple
Supreme

PAELLA STATION

\$19 Per Person

Seafood - prawns, mussels, calamari, pipis

CARVERY STATION

\$32 Per Person

Slow cooked beef served with seasonal roasted vegetables, dinner rolls, beef jus, seeded and dijon mustard

GELATO STATION

\$25 Per Person

Live Station - 1 HR Unlimited Ice Cream

Select up to 3 Flavours Below

strawberry, chocolate, vanilla, mint choc chip, salted caramel and pistachio.



OUR *philosophy*

The Newmarket Room Restaurant & Bar features a paddock to plate food philosophy providing simplistic, comforting and authentic flavours. Our Executive Chef and his skilled team deliver a menu that reflects a modern Australian twist. A menu to be shared with colleagues, family and friends.

NOTE FROM OUR *executive head chef*

The Newmarket Room strives on collaborative creation, innovative dishes and Australian native ingredients coming together with flavours that bounce off the plate.



OUR PLACE, YOUR *story*
