

## MEETINGS AND EVENTS

Elevate your meeting and events experience with Mövenpick BDMS Connect Center, a sustainable meeting center nestled in a tropical garden, in the heart of Bangkok.





Mövenpick Website



## CONTACT INFORMATION

Address: 2 Wireless Rd., Lumpini  
 Patumwan, Bangkok 10330, Thailand  
 T. +66 2 666 3333  
 E. resort.bdms.reservation@movenpick.com

- MovenpickBDMSBangkok
- @movenpickbdms
- movenpickbdmsbangkok
- www.movenpickbdmsbangkok.com

## Stay Well

The resort's 211 upscale rooms and suites all include private balconies and stylish and contemporary living spaces with views overlooking the resort's gardens or out across the city skyline. Whether travelling for leisure, business or as a family, there's an ideal room for you.

- 116-Deluxe Room (38 Sq. m.)
- 20-Deluxe Suite (74 Sq. m.)
- 11-Wellness Deluxe Room (38 Sq. m.)
- 46-Wellness Suite (74 Sq. m.)
- 14-Wellness Sleep Suite (74 Sq. m.)
- 2-Family Suite 1 Bedroom (69 Sq. m.)
- 1-Family Suite 2 Bedroom (99 Sq. m.)
- 1-Presidential Suite (164 Sq. m.)

## An Enchanting Oasis in the Heart of Bangkok

Located in the very heart of Bangkok, amidst ultra-modern shopping malls and a rich and eclectic culture, Mövenpick BDMS Wellness Resort Bangkok presents the perfect home from which you can fully enjoy this city. Just moments from the Ploenchit BTS Skytrain station, the whole city, with its countless unique attractions and potential stories, is easily reached.

The resort is a just short distance from extensive shopping at Central Embassy, CentralWorld, and Pratunam Market, as well as entertainment districts on Sukhumvit Road, allowing you to explore the City of Angels at your leisure.



### Live Well

Take advantage of a wide range of wellbeing and lifestyle experiences that will leave you feeling relaxed and refreshed.

#### Pool

Open daily: 6.00 am – 9.00 pm

#### Be Well Spa

Open daily: 10.00 am – 10.00 pm

#### Facilities:

- 7 treatment rooms
- Facial treatment room
- Dry Floatation experience
- Ice room

- Sauna and steam room
- Locker rooms for men and women

#### Be Fit Fitness Centre

Open daily: 24/7

#### Facilities:

- Fully equipped with LifeFitness equipment
- Steam rooms for men and women
- Locker rooms for men and women

#### In-Room Wellness Amenities:

- Yoga mat, stretch band, yoga ball
- iHome light and sound speaker for better sleep
- Pillow menu
- Health Brings Wealth book



#### Club Benefits:

- Exclusively for Wellness Rooms & Suites
- Daily lounge access
- Access to wellness classes
- Health and nutrition consultation



## Eat Well

At Mövenpick BDMS Wellness Resort Bangkok, indulge in a range of delectable dining experiences that both tantalise the taste buds and nourish the body.

## Nourish

The resort's all-day dining restaurant, Nourish offers sumptuous buffet breakfasts and lunch spreads that showcase a healthy take on both local and international cuisines, as well as an extensive à la carte menu. The restaurant is further renowned for its indulgent Sunday brunch that's popular with both resort guests and locals alike.

**Open daily:** 06.00 am – 5.00 pm

Breakfast on weekdays: 6.00 am – 10.30 am

Breakfast on weekends and holidays:

6.00 am – 11.00 am

Lunch: 11.00 am – 5.00 pm

## Khum Hom

Khum Hom is led by Chef Ian Kittichai, an award-winning chef, author and television personality renowned for his modern approach to Thai cuisine. A not-to-be-missed experience, guests enjoy an innovative interpretation of classic Thai dishes from the four regions of Thailand with views overlooking the resort's lush gardens. Khum Hom displays a passion for premium local ingredients given a modern twist through skilled application of refined cooking techniques.

**Opening daily:**

Lunch: 12 noon – 3.00 pm

Dinner: 5.30 pm – 10.30 pm

## Bittersweet

Gather and take in the social atmosphere of Bittersweet while savouring an extensive selection of skilfully created drinks, such as craft cocktails and premium aperitifs. Bittersweet is also the location for enjoying our daily complimentary Chocolate Hour, a Mövenpick signature experience.

**Open daily:** 10.00 am – 11.00 pm



## Rim Klong Café

Seated on the edge of the canal, Rim Klong Café is the place to go for everything from a quick grab and go snack or light meal to a relaxed cup of coffee, indulgent ice cream or tasty baked treat. Throughout the day you'll find an à la carte breakfast menu in the morning, afternoon tea and then drinks and tapas in the evenings.

**Open daily:** 7.00 am – 8.00 pm



## Harmony (Grand Ballroom)

*'Unveiling elegance from the understory'*

Floor space: 627sq m | Capacity: 500 people

Step into the Harmony Grand Ballroom, where the understory's enchanting energy comes alive. Bathed in natural daylight and adorned with captivating LED and dynamic lighting, it offers an immersive experience. With an advanced AV and seamless content transfer, your event's essence harmonizes, echoing the interconnected understory foliage.

Unveil automotive excellence in our Grand Ballroom with a lifting prowess of 3,000 kilograms at a maximum height of 2 meters. it's an ultimate event space that surpasses all expectations.

### Audio Facilities

- Wireless microphones conference
- Digital mixing console

### Visual Facilities

- LED Digital wall 15x5 m.
- Laser projector and screen 250"

## Serenity (VIP Room)

*'Nurtured understory tranquility reigns'*

Floor space: 53sq m | Capacity: 10 people

Discover a haven adorned with nature-inspired elements, where the quiet strength of the understory is beautifully reflected. With every detail thoughtfully curated, the Serenity VIP Room provides a tranquil escape for intimate gatherings, fostering connections, offering a sanctuary of calm and rejuvenation.

### Visual Facility

- TV 55"



## Harmony (Grand Ballroom)

Theater Classroom



500



280

Banquet Cocktail



350



500

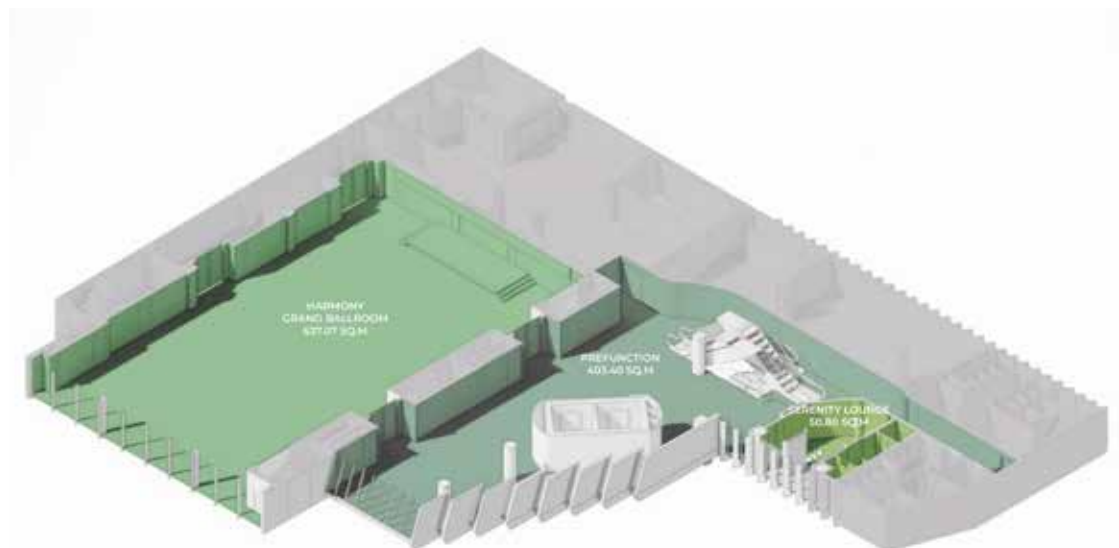

## Radiant (Junior Ballroom)

'Where brilliance shines bright'

Floor space: 357sq m | Capacity: 300 people

Radiant on the emergent floor, sets the stage for elevated gatherings. Seamlessly share content on Harmony's expansive screen, connect screens across rooms, and amplify communication with conference microphones. The radiant LED Digital curve wall, bathed in daylight and complemented by the unique design roof, fosters an environment where brilliance truly shine.

### Audio Facilities

- Wireless microphones conference
- Conference mixing console

### Visual Facilities

- LED Digital curve wall 7.6x4.3 m.
- Wireless presentation

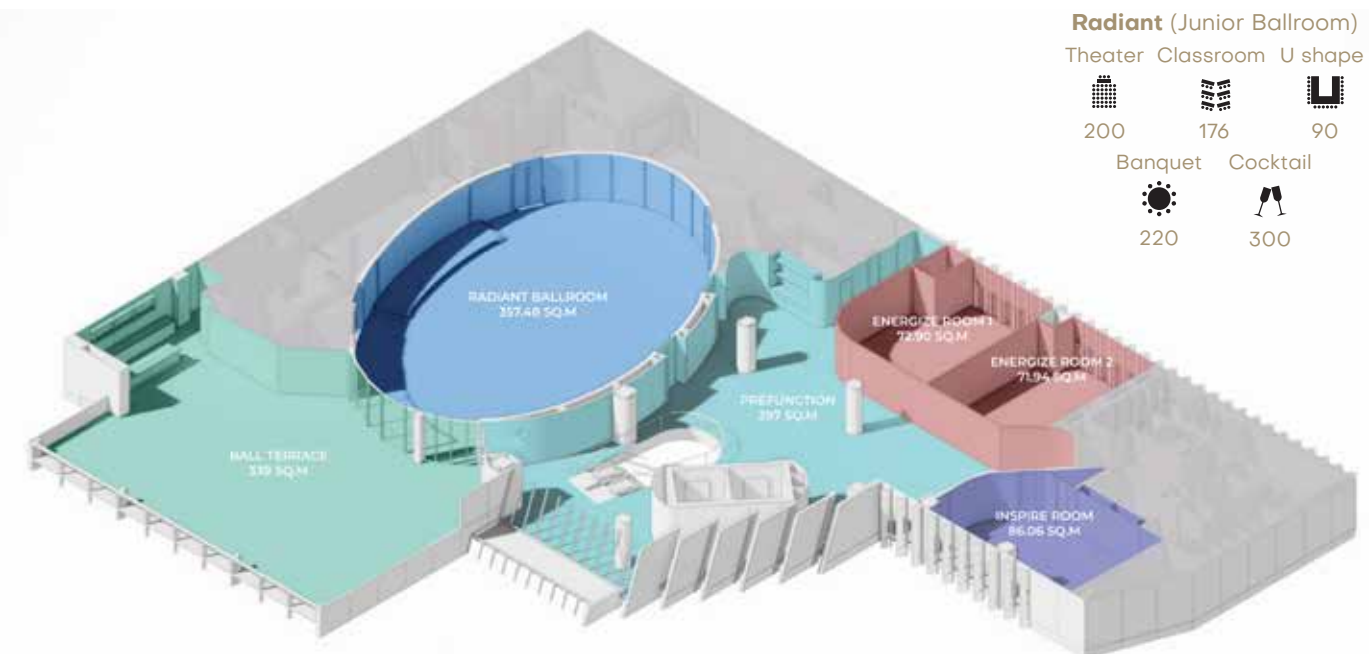



BDMS CONNECT CENTER Level 4

## Bliss (Outdoor Terrace)

'Networking amidst nature's splendor'

Floor space: 339sq m | Capacity: 100 people

Adjacent to the Radiant Junior Ballroom on the emergent floor, Bliss is an ideal space for evening cocktail events. With a stunning natural backdrop, it offers a sophisticated ambiance for memorable networking experiences. Connect with colleagues and partners in a setting that elegantly blends nature's allure and refinement.

### Audio Facility

- Portable audio system



## Energize I & II

'Energize your learning experience'

Floor space: 144sq m | Capacity: 120 people

Experience the seamless adaptability of Energize Rooms, effortlessly transforming into two meeting rooms for utmost versatility. Enrich your educational journey with a laser projector engaging in dynamic presentations and interactive discussions. Let state-of-the-art technology and a vibrant atmosphere elevate your learning to new heights.

### Audio Facility

- Wireless microphones conference

### Visual Facilities

- Laser projector and screen 150"
- Wireless presentation

## Inspire

'Igniting ideas on the emergent floor'

Floor space: 85sq m | Capacity: 70 people

An oasis of relaxation and productivity. The surrounding natural scenery offer the perfect conditions for creative workshops or brainstorming sessions. Designed to accommodate diverse meeting needs, this space is equipped with a laser projector that amplifies your presentations.

### Audio Facility

- Wireless microphones conference

### Visual Facilities

- Laser projector and screen 150"
- Wireless presentation



### Energize I & II

Theater Classroom U shape



72



50



30

Banquet



80

Cocktail



120

### Inspire

Theater Classroom U shape



72



50



20

Banquet



40

Cocktail



60

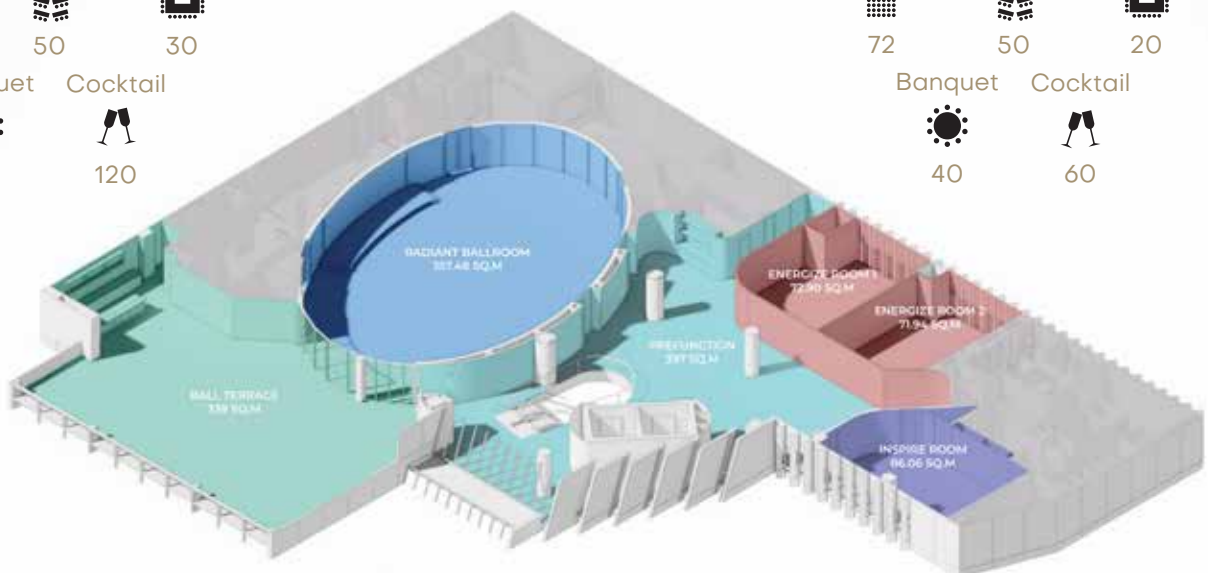



## Focus I & II

'Unlocking innovation amidst canopy heights'  
 Floor space: 144sq m | Capacity: 120 people

Ideal for larger gatherings and collaboration, these spaces seamlessly adapt, transforming into two meeting rooms. Bathed in daylight, engage precisely with the laser screen and advanced sound system. Unleash creativity amid this inspiring canopy setting where ideas take flight in the midst of the lush canopy's embrace.

### Audio Facility

- Wireless microphones conference

### Visual Facilities

- Laser projector and screen 150"
- Wireless presentation



## Balance

'Elevate discourse amidst canopy heights'  
 Floor space: 85sq m | Capacity: 60 people

Ideal for formal gatherings and fostering creative environments, the space offers the perfect backdrop for both in-person and online meetings. With seamless audio and visual connectivity across every room, your discussions flow effortlessly, capturing the harmonious spirit of the canopy.

### Audio Facility

- Wireless microphones conference

### Visual Facilities

- Laser projector and screen 150"
- Wireless presentation



### Focus I & II

Theater Classroom U shape



72



50



30

Banquet



80

Cocktail



120

### Balance

Theater Classroom U shape



36



24



15

Banquet



40

Cocktail



60

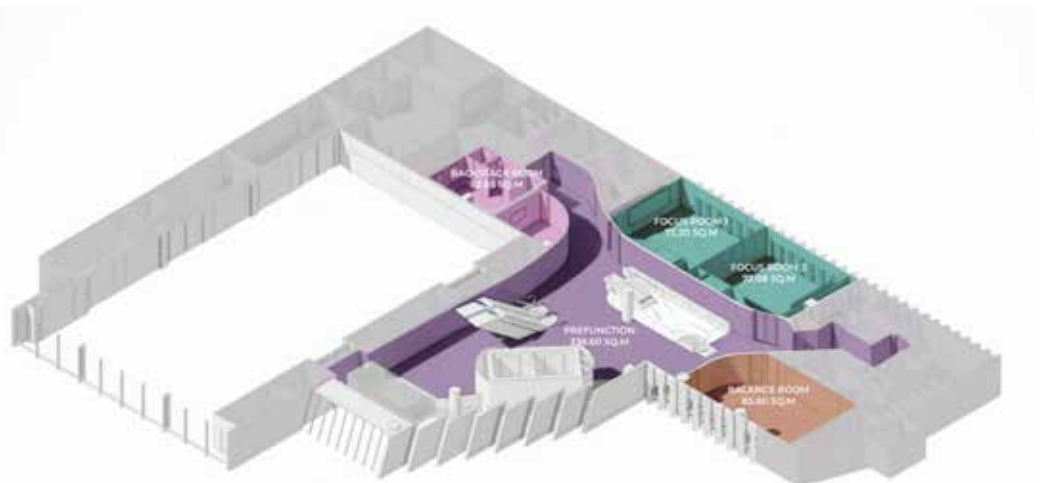





## Refresh

'Journey into the heart of the forest: Refresh your senses'

Floor space: 133sq m | Capacity: 100 people

### Audio Facilities

- Wireless microphones conference
- Digital mixing console

### Visual Facilities

- Laser projector and screen 150"
- Wireless presentation



## Renew

'Journey into the heart of the forest: Renew your connection'

Floor space: 192sq m | Capacity: 150 people

Unveil the enchantment of the forest floor within our Refresh and Renew. Ideal for exhibitions meetings and training, the spaces seamlessly bridge the gap between you and the captivating essence of the rainforest's underbelly. Featuring an advanced AV system, projector, LED screen, and dynamic RGB lighting, you will be immersed in an experience that brings the forest's wonders to life in every hue and detail.

### Audio Facilities

- Wireless microphones conference
- Digital mixing console

### Visual Facilities

- LED wall 4x2 m.
- Wireless presentation



### Refresh (Exhibition)

Theater Classroom U shape



100



70



35

Banquet



80

Cocktail



100

### Renew (Exhibition)

Theater Classroom U shape



140



100



40

Banquet



120

Cocktail



150

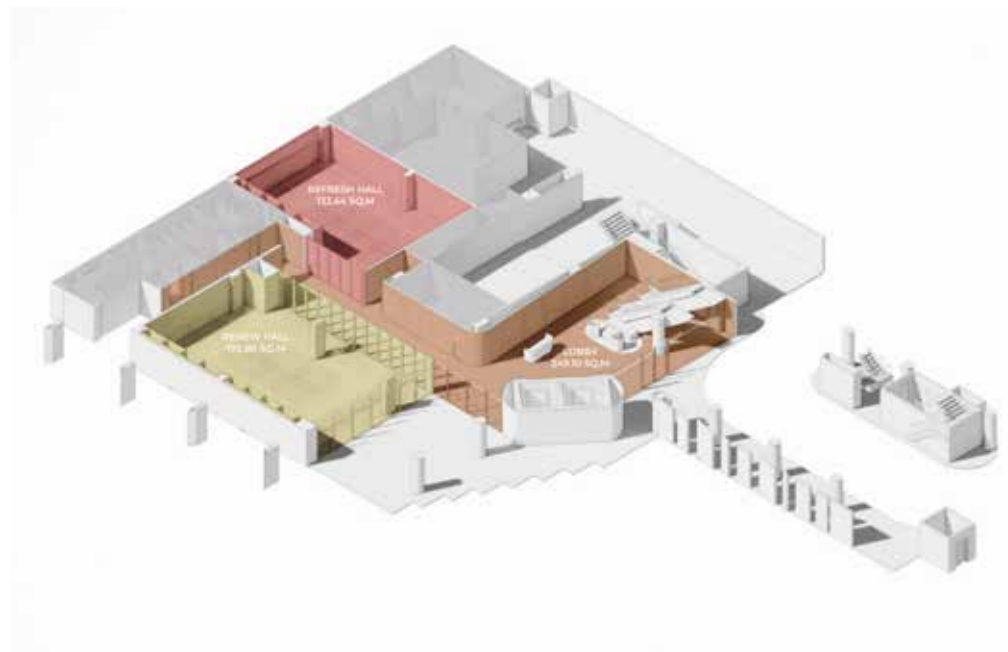



MÖVENPICK BDMS WELLNESS RESORT BANGKOK

## Be Creative

'Where ideas connect'

Floor space: 84sq m | Capacity: 70 people

Experience innovation at its finest within the modern confines of Be Creative. This space is a fusion of contemporary design and the invigorating embrace of natural daylight. Our cutting-edge conference facilities ensure seamless interactions, making Be Creative the ultimate choice for impactful business meetings, conferences, and transformative training sessions.

### Audio Facilities

- Wireless microphones
- Wireless conference

### Visual Facilities

- Projector and screen 150"
- TV 75"
- Wireless presentation

### Be Creative

Theater



70

Classroom



50

U shape



30

Banquet



50

Boardroom



20

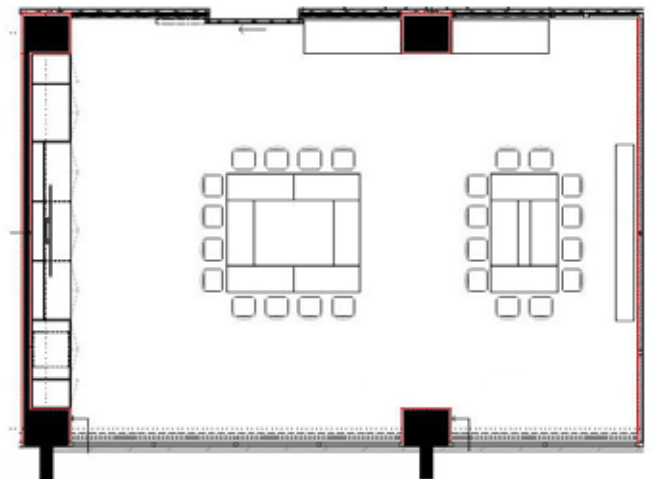



MÖVENPICK BDMS WELLNESS RESORT BANGKOK

## Be Social I & II

'Where collaborations come to life'

Floor space: 84sq m | Capacity: 50 people

Ideal for small to medium functions or personal celebrations, the Be Social room is stylishly decorated in earthy tones. It offers a natural daylight and space can be separated in several ways into 2 smaller meeting rooms. Guests can rest assured that every detail will be expertly managed by our skilled event team.







### Audio Facility

- Portable wireless microphones

### Visual Facility

- Moveable projector and screen 120"



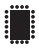

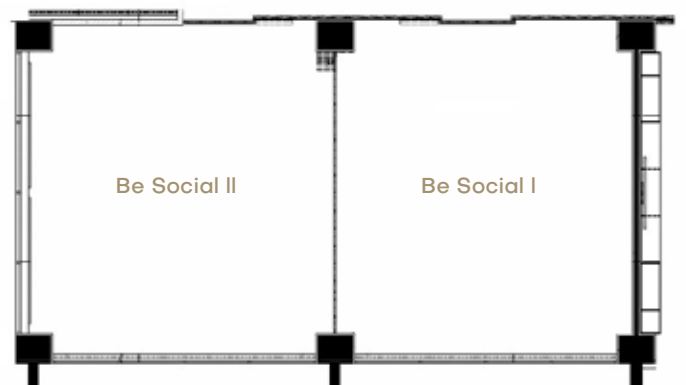
### Be Social I & II

Theater	Classroom	U shape	Banquet	Boardroom
				
40	50	20	40	18



## BDMS Connect Center





A world-class 627 sq.m. Grand Ballroom catering over 500 persons.

Dimension				Capacity				
Function room	Floor	Size/sq.m.	Ceiling Height/m.	 Theatre	 Classroom	 U shape	 Banquet	 Cocktail
Refresh	L1	133	3.5	100	54	35	80	100
Renew	L1	192	3.5	140	72	40	100	150
Harmony	L2	627	8	500	234	90	350	450
Harmony I	L2	318	8	160	72	57	120	200
Harmony II	L2	309	8	200	144	63	180	250
Serenity	L2	53	4.6	-	-	-	-	-
Focus I & II	L3	144	3.5	72	50	30	80	120
Focus I	L3	72	3.5	36	24	15	40	60
Focus II	L3	72	3.5	36	24	15	40	60
Balance	L3	85	3.5	36	24	15	40	60
Radiant	L4	357	6	200	120	80	140	200
Energize I & II	L4	144	3.6	72	48	36	80	120
Energize I	L4	72	3.6	36	24	18	40	60
Energize II	L4	72	3.6	36	24	18	40	60
Inspire	L4	85	3.6	36	24	15	40	60
Bliss Outdoor Terrace	L4	339	100 cocktail style					

## ROOM DIMENSIONS AND CAPACITIES

### Mövenpick BDMS Wellness Resort Bangkok

The smaller 42 sq.m. is ideal for more intimate meetings.

Dimension			Capacity				
Function room	Space/sq.m.	Ceiling Height/m.	 Theater	 Classroom	 U shape	 Banquet	 Boardroom
Be Creative	84	2.4	70	50	30	50	20
Be Social I & II	84	2.4	40	50	20	40	18
Be Social I	42	2.4	20	N/A	10	N/A	8
Be Social II	42	2.4	20	N/A	10	N/A	8



## Discover unique add-on experiences for your event

Welcome to a world of enriching experiences that can elevate your meeting to a whole new level! With an additional fee, you can customize your meeting to create memories that can be cherished long after it concludes.

### 1. Cultivate Creativity

Get your hands dirty and tap into your creativity with our Terrarium Workshop. Craft your own miniature ecosystems within elegant glass containers. This hands-on activity not only promotes relaxation but also encourages teamwork.

### 2. Taste of Authenticity

Embark on a culinary journey that showcases the essence of the local culture. Introduce your attendees to the vibrancy of local street food vendors or set up a festival-style food booth. Savor the diverse flavors and aromas that encapsulate the region, giving your event an unforgettable taste of authenticity.

### 3. Nurturing Wellness

Elevate your event's value by incorporate health and wellness. Engage with a medical professional who will deliver insights into various health-related topics. This is an excellent fit for conferences focusing on well-being or corporate wellness events, providing attendees with practical takeaways for a healthier lifestyle.

### 4. Discover Local Treasures

Unveil the beauty of Bangkok through captivating boat or bus tours. Allow your attendees to immerse themselves in the local culture, soaking in the sights and sounds that make the area

unique. This engaging experience offers a refreshing break from meetings while enriching their understanding of the location.

### 5. Nourish Your Body and Soul

Prioritize well-being with our range of rejuvenating experiences. From invigorating fitness classes like boot camp or yoga to hands-on DIY spa product sessions, attendees can indulge in "me-time". Additionally, our organic fragrance workshop offers a delightful exploration of scents and relaxation.

### 6. Culinary Adventure for Healthy Living

Embark on an exotic culinary journey with a renowned chef, centered around healthy living. Discover the secrets of preparing delectable Thai cuisine that tantalized the taste buds while promoting a balanced lifestyle. This cooking class will leave attendees both educated and inspired.

### 7. Networking in Style

Unwind and connect in a laid-back setting with our Bliss BBQ experience. Set against a stunning backdrop, this casual gathering provides the perfect opportunity for networking and team bonding. Strengthen relationships and create lasting memories as you savor delicious food and enjoy the company of fellow attendees.

Whether you're seeking creativity, culinary exploration, wellness, culture, or relaxation, we've curated a selection that caters to every palate. Elevate your event and make it an unforgettable journey with us.



SCAN FOR MAP

**Mövenpick BDMS Wellness Resort Bangkok**

2 Wireless Rd., Lumpini, Pathumwan  
Bangkok 10330 | Thailand  
Phone +66 2 666 3333  
resort.bdms.sales@movenpick.com

