

PULLMAN BANGKOK KING POWER

MICE HOTEL IN BANGKOK



pullman
HOTELS AND RESORTS

THE PLACE TO MEET

- Located on Rongnam Road, next to the King Power Duty Free Downtown Complex
- Transfer to/from Suvarnabhumi Airport is about 40 minutes via Suvarnabhumi Airport Rail Link (SARL) at Phayathai Station, which is within walking distance
- Easy access to BTS Skytrain at Victory Monument Station (Exit No.2)
- FREE Shuttle Tuk-Tuk service - to/from the hotel



354

**ELEGANT AND COMFORTABLE
ROOMS WITH FREE WiFi**

163 Superior

100 Deluxe

including 2 rooms for disabled guests

18 Deluxe with Private Balcony

52 Executive

21 Suite

** 6 USB charging ports at Deluxe,
Executive and Suite*





SUPERIOR ROOM

32 sq.m.

- Coffee and tea making facilities
- 40-inch LED Smart TV
- FREE WiFi and Wireless LAN
- Separate rain shower and bathtub
- C.O. Bigelow toiletries from New York
- In-room iron & ironing board & hair dryer
- Yukata and slippers
- FREE 2 bottles of water per day (cannot be accumulated)
- Complimentary online newspaper
- 20% discount shopping coupon for 1 item and 10% discount shopping coupon at King Power Rangnam Complex, next to the hotel



DELUXE ROOM 32 sq.m.

(IN ADDITION TO SUPERIOR ROOM BENEFITS)

- 49-inch LED Smart TV
- 6 USB charging ports
- Separate rain shower & bathtub & bath salts
- 20% discount shopping coupon for 1 item and 15% discount shopping coupon at King Power Rangnam Complex, next to the hotel
- FREE 2 soft drinks from your mini bar per day (cannot be accumulated)





EXECUTIVE ROOM 32 SQ.M.

(IN ADDITION TO DELUXE ROOM BENEFITS)

- Personalized concierge service
- In-room Nespresso® machine
- Pillow menu
- VIP amenities
- Free local calls (for landlines with the prefix (02) only)
- In-room fitness; yoga mat and 2 free weights
- Complimentary magazines
- 1 piece of complimentary laundry per day (cannot be accumulated) and shoeshine service
- 15% discount on laundry and dry cleaning service
- 20% discount shopping coupon for 1 item and 15% discount shopping coupon at King Power Rangnam Complex, next to the hotel
- Exclusive access to Executive Lounge with benefits on the 20th floor, open daily from 06.00 - 23.00 hrs.
- Exclusive access to the King Power Airport Lounge at Suvarnabhumi Airport - Concourse A of passenger departure terminal

SUITE 64 SQ.M.

(IN ADDITION TO EXECUTIVE ROOM BENEFITS)

- A private bedroom and separate living area with sofa and work/dining table
- 49-inch LED Smart TV at bedroom and 55-inch at living room
- Essential oil burner

**EXECUTIVE LOUNGE ON THE 20TH FLOOR
AT PULLMAN BANGKOK KING POWER**



ACCESS TO THE EXECUTIVE LOUNGE

- Private hotel check in and out
- Daily breakfast from 06.00 - 10.30 hrs. on weekdays and 06.00 - 11.00 hrs. on weekends in the Executive Lounge or Cuisine Unplugged
- Evening cocktails & canapés from 17.00 - 19.00 hrs.
- All-day complimentary coffee, tea, juices, soft drinks, fresh fruits and cookies
- Boardroom to conduct meetings (limited to one hour per stay)
- Use of the library at the Executive Lounge
- Exclusive access to the King Power Airport Lounge at Suvarnabhumi Airport - Concourse A of passenger departure terminal



**KING POWER AIRPORT LOUNGE
AT SUVARNABHUMI AIRPORT**



CREATIVE DINING OPTIONS

The Junction At Pullman, the lobby design with co-working space. When barista meets pop-up bar and when morning pastries meet tapastries

Cuisine Unplugged, a buffet concept built around green and organic ingredients

Tenshino, a chic innovative Japanese restaurant with unique Japanese dishes for dinner

Glen Bar, a stylist destination bar, inspired by Very Thai concept with mezzanine lounge
Cool refreshment, cocktails and snacks available at **Pool Bar**

TENSHINO RESTAURANT

A chic innovative Japanese restaurant with a touch of bohemian chic. Featuring both communal and individual tables for social dining where guests can enjoy unique Japanese dishes for dinner.

Located on the 2nd floor.
Open from 18.00 – 23.00 hrs.

CHILDREN ARE WELCOME WITH
FAMILY



WELL-BEING EXPERIENCE

- **Pullman Fit and Spa**, combining Pullman well-being concept based on 4 universe pillars of well-being: SLEEP, FOOD, SPORT & SPA

Located on the 4th floor

- Rejuvenation at **Le Spa**, with a choice of treatments such as Endermologie® slimming treatments, facial treatments by Laboratoires Filorga, Hammam rituals and head to toe body massages from Panpuri.

Open from 09.00 - 22.00 hrs.

- Relaxation at **Fitness Center**, dedicated space with high-tech equipments and 27- meter infinity swimming pool.

Open from 06.00 - 22.00 hrs.



HIGH-LEVEL MEETING EQUIPMENTS AND SERVICES

Co-Meeting by Pullman concept featuring 20 meetings, including 2 ballrooms

ETERNITY BALLROOM, the latest daylight ballroom with pre-function space, open kitchen and dedicated car access

INFINITY BALLROOM with pre-function space and divided into 2 rooms

CHILL OUT SPACE with innovative themed coffee breaks

Shaking up meetings at Business Playground

Dedicated event specialists

Free WiFi throughout the hotel



THE ETERNITY BALLROOM

Offering up to 500 guests with natural daylight throughout, and cutting-edge technology complemented by a customised open kitchen from Italy's Marrone, as well as an additional dedicated car access for vehicle exhibitions.

- An impressive 470 sq.m. with ceiling height 6.50 m.
- A 110 sq.m. of Pre-Function
- 2 main entrances (W 1.89 m. & H 2.80 m. each)
- 3 Built-in projectors with 7,000 lumens
- 3 screens (main screen of 307 inches and 2 screens of 278 inches)
- Professional sound and audio systems: built-in speakers, 7 sockets, 8 points of mic and audio support
- An additional dedicated car entrance for vehicle exhibitions (W 2.80 m. & H 2.90 m.)

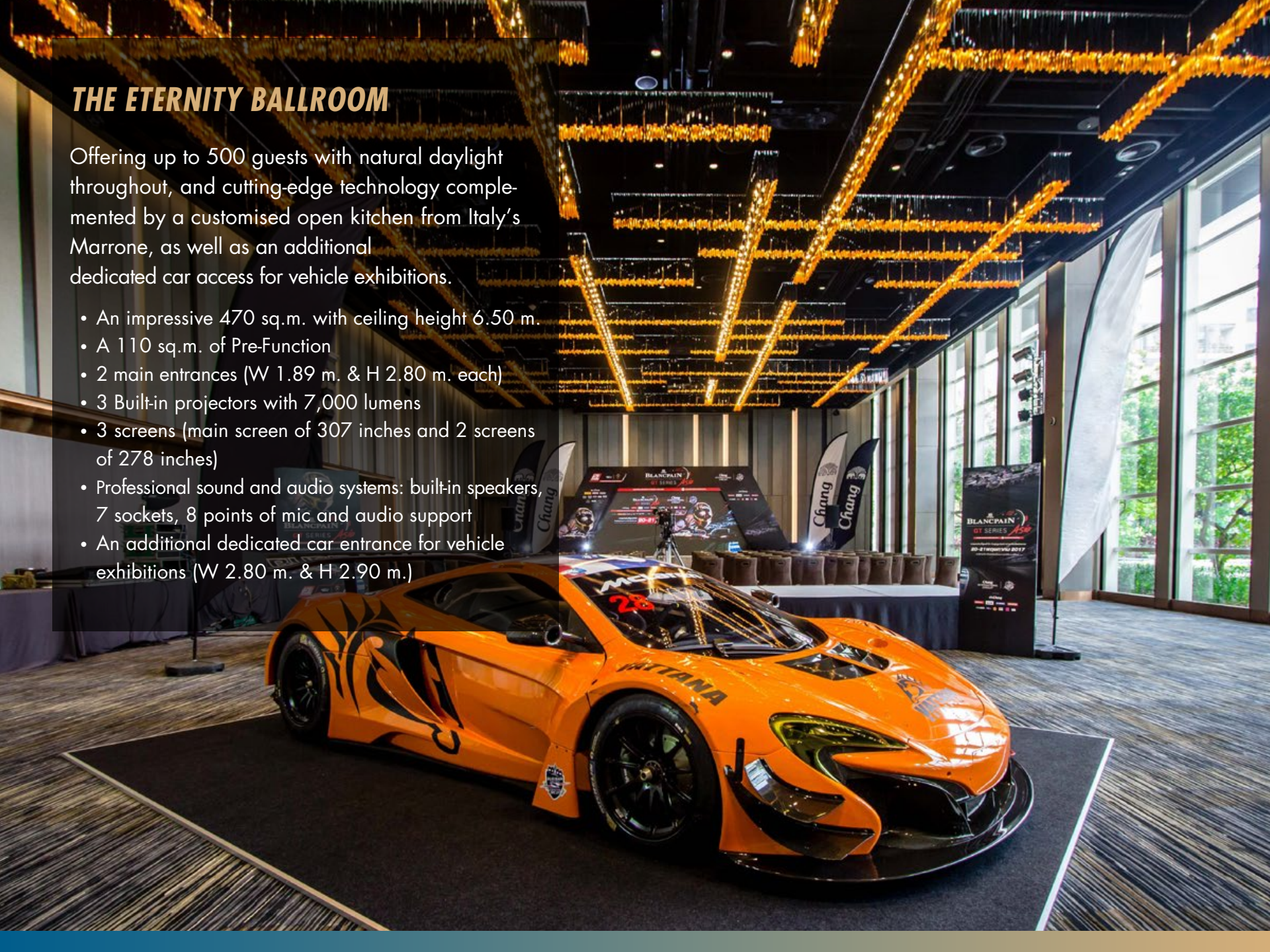



THE INFINITY BALLROOM

Located directly opposite, the Infinity ballroom, with its 600-guest capacity, can be divided into 2 rooms with in-function and post-function

- An impressive 600 sq.m. with ceiling height 7.00 m.
- A 190 sq.m. of Pre-Function
- 2 main entrances (W 1.80 m. & H 4.00 m. each)
- 2 Built-in projectors with 10,000 lumens
- 2 screens
- Professional sound and audio systems

* For both the Infinity and Eternity ballrooms, the parking space area is permitted to be used as the loading area for small trucks







THE SECOND

The Second is a dedicated meeting area on the 2nd floor, equipped with multi-purpose meeting facilities that can adapt to your event's needs and also offers direct support from the adjacent business center with boardroom and secretarial services.





DEJA VU

Enjoy a stylish space with a contemporary ambiance for your next private party in Bangkok.

Déjà Vu is located on the 2nd floor of the Glass Tower in its own private zone. It can accommodate up to 200 guests and features an elegant 7.5-meter high ceiling and comfortable foyer.

This venue can be designed as creatively as you wish to fulfil your exact requirements.









THE SIXTH

The Sixth, all meeting rooms offer natural daylight and chill-out spaces making them ideal as a private or socialize area and are decorated in stylish interior design perfect for unwinding, relaxing and catching up after your meeting.

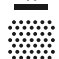

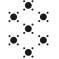





MEETING ROOM AND BANQUETING CAPACITIES

| Capacity of each layout | |  |  |  |  |  |  |
|-------------------------|------------|---|---|---|--|---|---|
| Function room | Area (sqm) | U-Shape | Theatre | Classroom | Banquet | Cocktail | Boardroom |
| Ground Floor | | | | | | | |
| Eternity Ballroom | 470 | 50 | 414 | 256 | 280 | 500 | 40 |
| Infinity Ballroom | 600 | 90 | 550 | 350 | 400 | 600 | - |
| (Combined 1 or 2) | 300 | 40 | 200 | 120 | 120 | 200 | 36 |
| Botanical Garden | - | - | - | - | 50 | 60 | - |
| 2nd Floor | | | | | | | |
| Alpha Room | 85 | 30 | 75 | 50 | 50 | 60 | 24 |
| Beta Room | 110 | 40 | 100 | 60 | 60 | 90 | 36 |
| (Combined 1 or 2) | 50 | 20 | 50 | 30 | 30 | - | 18 |
| Gamma Room | 50 | 20 | 50 | 30 | 30 | - | 18 |
| Delta Room | 50 | 20 | 50 | 30 | 30 | - | 18 |
| Epsilon Room | 50 | 20 | 50 | 30 | 30 | - | 18 |
| Déjà Vu | 427 | 26 | 100 | 60 | 100 | 140 | 24 |
| 6th Floor | | | | | | | |
| Chill Out Space | 56 | - | - | - | - | 40 | - |
| Omega Room | 89 | 30 | 80 | 39 | - | - | 24 |
| Sigma Room | 112 | 38 | 120 | 66 | - | - | 36 |
| (Combined 1 or 2) | 56 | 20 | 60 | 27 | - | - | 18 |
| Kappa Room | 56 | 20 | 60 | 27 | - | - | 18 |
| Theta Room | 56 | 20 | 60 | 27 | - | - | 18 |







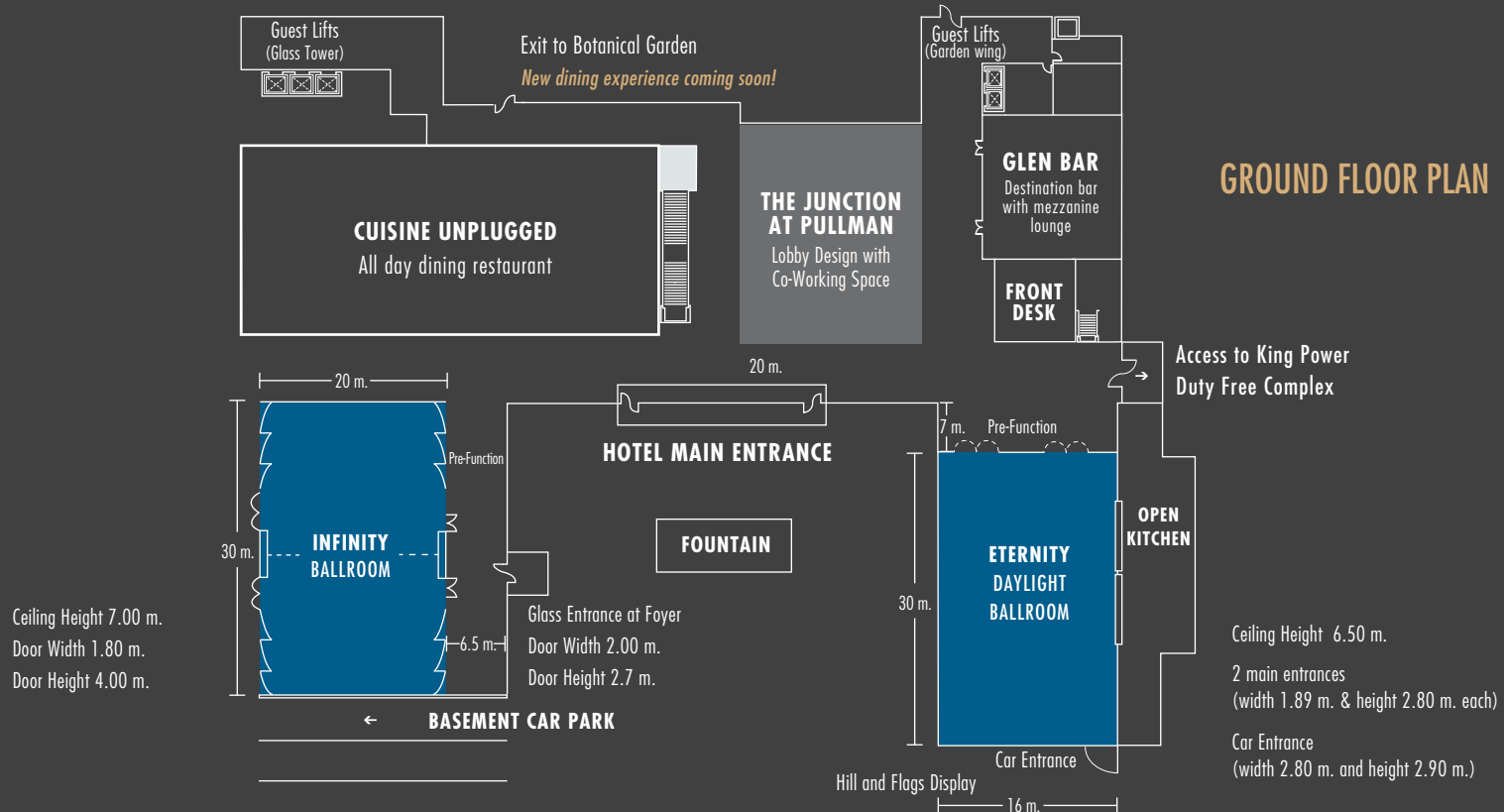

MEETING ROOM AND BANQUETING CAPACITIES

| CAPACITY | |  |  |  |  |  |  |
|------------------------------|------------|---|---|---|---|---|---|
| Function Room | Area (sqm) | U-Shape | Theatre | Classroom | Banquet | Cocktail | Boardroom |
| Ground Floor | | | | | | | |
| Eternity Ballroom | 470 | 50 | 414 | 256 | 280 | 500 | 40 |
| Infinity Ballroom | 600 | 90 | 550 | 350 | 400 | 600 | - |
| (Divided 1 or 2 at Infinity) | 300 | 40 | 200 | 120 | 120 | 200 | 36 |







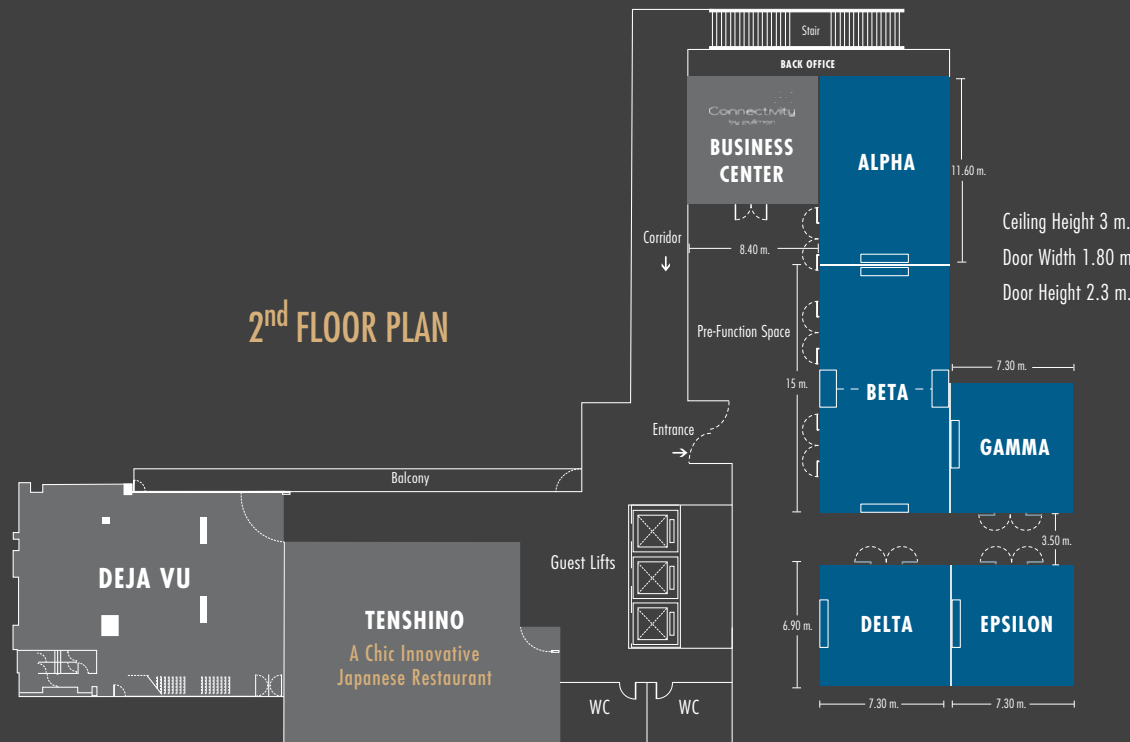

MEETING ROOM AND BANQUETING CAPACITIES

| CAPACITY | |  |  |  |  |  |  |
|-----------------------------|------------|---|--|---|---|---|---|
| Function Room | Area (sqm) | U-Shape | Theatre | Classroom | Banquet | Cocktail | Boardroom |
| 2nd Floor | | | | | | | |
| Alpha Room | 85 | 30 | 75 | 50 | 50 | 60 | 24 |
| Beta Room | 110 | 40 | 100 | 60 | 60 | 90 | 36 |
| (Divided 1 or 2 at Beta) | 50 | 20 | 50 | 30 | 30 | - | 18 |
| Gamma Room | 50 | 20 | 50 | 30 | 30 | - | 18 |
| Delta Room | 50 | 20 | 50 | 30 | 30 | - | 18 |
| Epsilon Room | 50 | 20 | 50 | 30 | 30 | - | 18 |



MEETING ROOM AND BANQUETING CAPACITIES

| CAPACITY | |  |  |  |  |  |  |
|-----------------------------|------------|---|---|---|---|---|---|
| Function Room | Area (sqm) | U-Shape | Theatre | Classroom | Banquet | Cocktail | Boardroom |
| 6th Floor | | | | | | | |
| Chill Out Space | 56 | - | - | - | - | 40 | - |
| Omega Room | 89 | 30 | 80 | 39 | - | - | 24 |
| Sigma Room | 112 | 38 | 120 | 66 | - | - | 36 |
| (Divided 1 or 2 at Sigma) | 56 | 20 | 60 | 27 | - | - | 18 |
| Kappa Room | 56 | 20 | 60 | 27 | - | - | 18 |
| Theta Room | 56 | 20 | 60 | 27 | - | - | 18 |

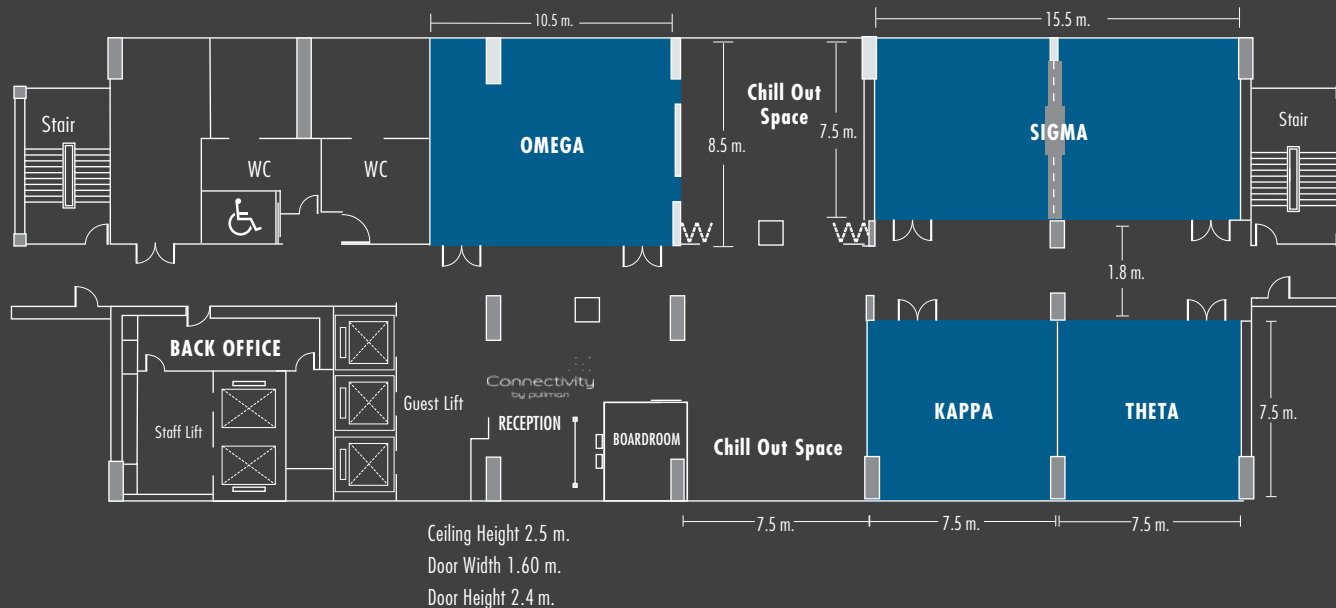

[business playground]

Shaking up meetings

Discover a destination bar with private mezzanine. Enjoy memorable beverages, dishes and live performances inspired by 'Very Thai' concept.

A perfect place to meet up after work, relax with your favourite glass or host a private party.

Size of LED screen: W 2.4 m. x W 4.8 m.



[business playground]
Shaking up meetings



Ceiling Height 7 m.
Door Width 1.80 m.
Door Height 7 m.

GLEN BAR UP TO 90 GUESTS

TERMS AND CONDITIONS

May be reserved for private functions
utilising existing setup (*)

Audio visual equipments can be catered for.

(*) Additional venue fees may apply

[business playground]
shaking up meetings

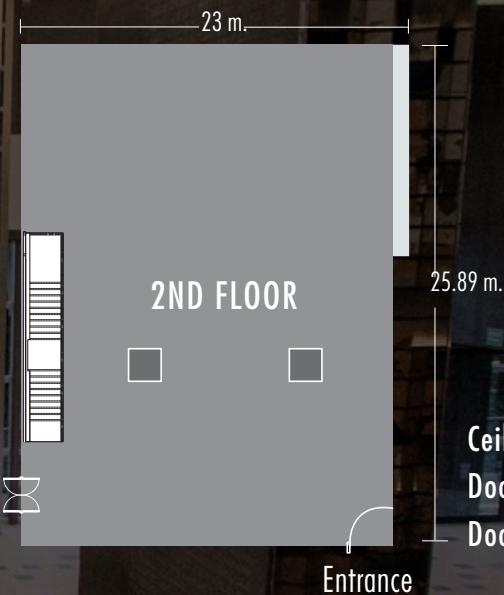

Ceiling Height 7.50 m.
Door Width 1.35 m.
Door Height 2.30 m.

DEJA VU

UP TO 120 GUESTS

TERMS AND CONDITIONS

May be reserved for private functions
utilising existing setup (*)

Audio visual equipments can be catered for.

(*) Additional venue fees may apply

LOCATION

PULLMAN BANGKOK KING POWER

8/2 Rangnam Road, Thanon-Phayathai, Ratchathewi, Bangkok 10400, Thailand

T.+66 (0) 2680 9999 F.+66 (0) 2680 9998

E-mail: hotel@pullmanbangkokkingpower.com

WWW.PULLMANBANGKOKKINGPOWER.COM

BY PLANE:

1. Suvarnabhumi International Airport (BKK): 40 mins by taxi via expressway
2. Don Muang Airport (DMK): 30 mins by taxi via expressway

BY AIRPORT RAIL LINK (ARL):

30 mins to/from Suvarnabhumi International Airport via the Suvarnabhumi Airport Rail Link - Phayathai Station is within walking distance

By **BTS SKYTRAIN**: Victory Monument Station (Exit no. 2) with complimentary hotel shuttle tuk-tuk service – to/from the hotel

CONTACT PERSON

Ms. Waleeporn Chai-In

Assistant Director of Sales - Corporate & Mice

T.+66 (0) 2680 9999 Ext. 2507

E-mail: H6323-SM6@ACCOR.COM

CHAENGWATTANA EXPRESSWAY
TO EXIT MUANG THONG THANI
then turn right along the road
(30 mins from Pullman Bangkok King Power)

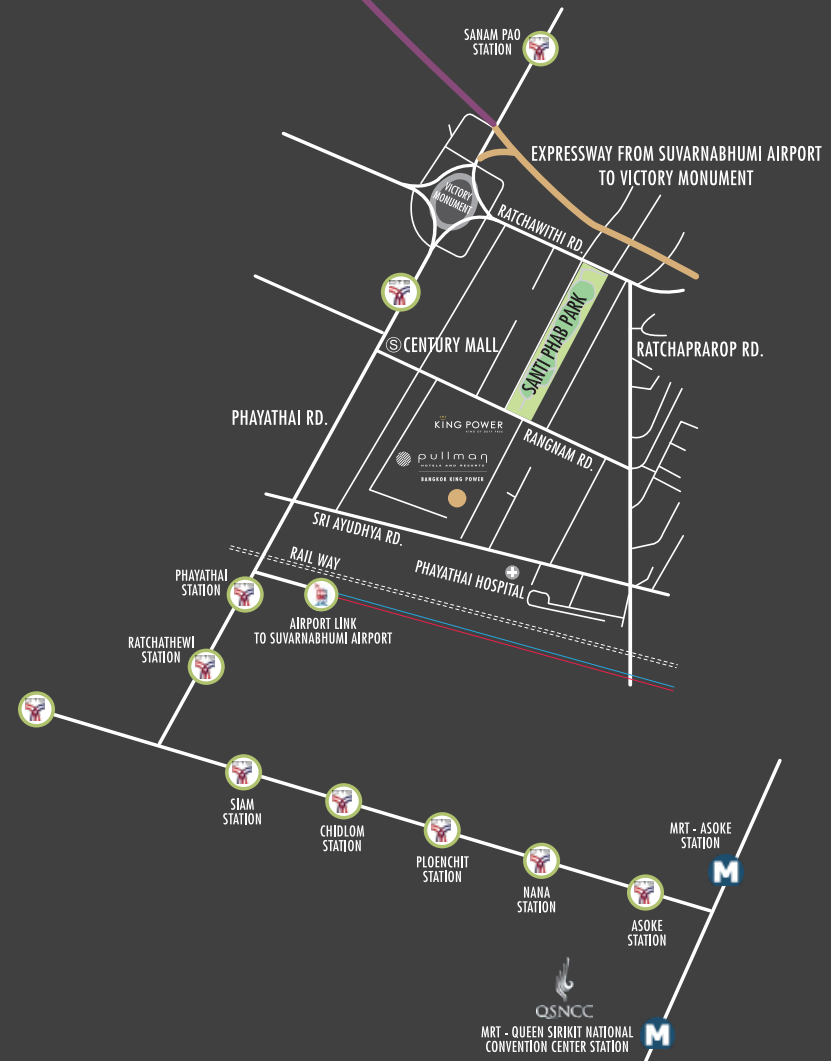



Feel Welcome

WHEN ONLY THE BEST WILL DO FOR MEETING PLANNER

Lily And Daniel Enjoy The Benefits Of Le Club AccorHotels Meeting Planner, the loyalty program designed exclusively for event organizers. Join today and join them too.

- No back out dates to redeem points
- No cap on earning per event
- Redeem on next meeting
- Free to join
- Points never expire

MEETIN PLANNER

So many reasons
TO JOIN

JOIN NOW at accorhotels.com/meetingplanner

Terms and conditions apply



SOFITEL
LEGEND

SO
SOFITEL

SOFITEL

M
GALLERY

PULLMAN

QUAY WEST

THE
SEBEL

GRAND MERCURE

NOVOTEL

Mercure

ibis

ibis
STYLES